

Air Operated Double Diaphragm Pumps **TC-X**

— TC-X200 Plastic —

¾" Plastic Diaphragm Pump Data Sheet

Max Flow Rate: 120 L/min. (Rubber)

Liquid Connections: ¾" Female / Flange Side-ports.

Max Slurry Size: 2.0 mm.

Max Suction Lift: PTFE Dry: 1.5m Rubber Dry: 3.0m. Wet (Primed): 8.0m.

Max Discharge Pressure: 0.7 Mpa.

Check Valve Configuration: Ball Valves.

Pump Wetted Material Options: PPG.

Diaphragm Options: PTFE, CR, NBR, TPEE, TPO, EPDM, FKM.

Air Motor Material: PPG. (Optional CFPP).

Description: ¾" Plastic AODD Pumps available in PPG. Looped C® Spring Air Spool. PPG / CFPP Air Motor. Threaded / Flanged Side Port Connections. Large Range of Diaphragm Options. Ball Check Valves. External Exhaust Silencer.

Pump Features: ¾" Plastic AODD Pumps fitted with the Looped C® Air Spool, Ekonol® Seal Rings & fully Independent Pilot Valves for increased performance, reliability & extended life cycle. Drop-in dimensions & footprint. Fully bolted body, heavy-duty construction & wide sturdy PP Plastic base. Manufactured from high grade reinforced engineering plastics for mechanical strength, rigidity, abrasion resistance & chemical stability. 100% oil or grease lubrication free, offering clean, emissions free, environmentally friendly operation. Easily maintainable with fully modular replaceable wear parts, outside accessible Air Spool & manual Spool Reset Switch. Fully torqued, leak and operation tested prior to shipment. Designed and manufactured in Japan.



TC-X200G□J/A
¾" PPG AODD Pump.



200 Plastic Pump Specifications

Pump Model / Material	G□	GT
Max Flow Rate	120 L/min [31.7 GPM]	100 L/min [26.4 GPM]
Max Solids Size	2.0mm	
Max Discharge Pressure	0.7 Mpa [100 psi]	
Supply Air Pressure Range	0.2 - 0.7 MPa [30 - 100 psi]	
Max Suction Lift	PTFE Dry: 1.5 meters. Rubber Dry: 3.0 meters. Wet (Primed): 8.0 meters.	
Max Air Consumption	1200 L/min (ANR) [42.4 SCFM]	1400 L/min (ANR) [49.5 SCFM]
Max Discharge Volume Per Cycle	350 mL	240 mL
Ambient Temperature Range	0 – 70°C [32 – 158°F]	
Liquid Temperature Range	0 – 60°C [32 – 140°F]	
Connections: Suction & Discharge	¾" Female Threaded / Flanged Side-ports	

Note: Factors affecting a pumps stated liquid flow rate, suction lift & solids handling capabilities include but are not limited to; pump size, diaphragm, ball valve & ball seat, type & materials of construction, air inlet pressure & air flow capability, liquid viscosity, specific gravity, slurry content, ambient & liquid temperature, liquid inlet & liquid outlet width, piping type, piping length & overall piping configuration. A minimum supply air pressure of 30 PSI (0.2 MPa) is required to operate the pump. If the supply pressure is less than 30PSI (0.2 MPa), the pump may not operate properly. Oil & Grease Lubrication is not required under normal operating conditions. All 200 Series Diaphragm Pumps are shipped complete with Polypropylene Plastic Base, Rubber Feet, Air Inlet Shutoff Valve & External Plastic Exhaust Silencer as Standard Accessories.

Nomenclature

TC-X

TC-X 200 G V A □ - □ X

- Pump Series
- Connection Size & Series
- Body Material (Wetted)
- Diaphragm Materials
- Connection Options
- Specialty Options
- Air Motor Options
- Other Options

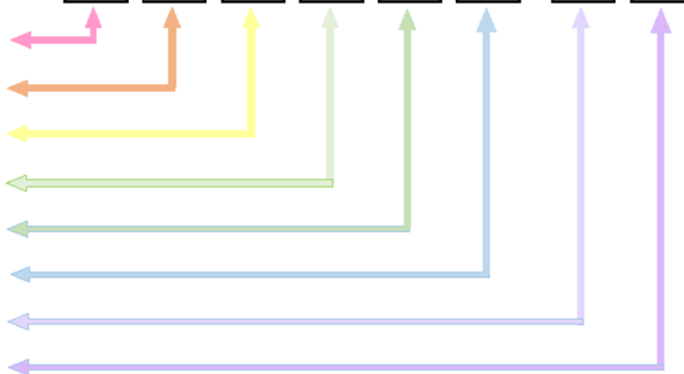

TC-X200V□
¾" CF PVDF Pump



Rubber Diaphragm Curves

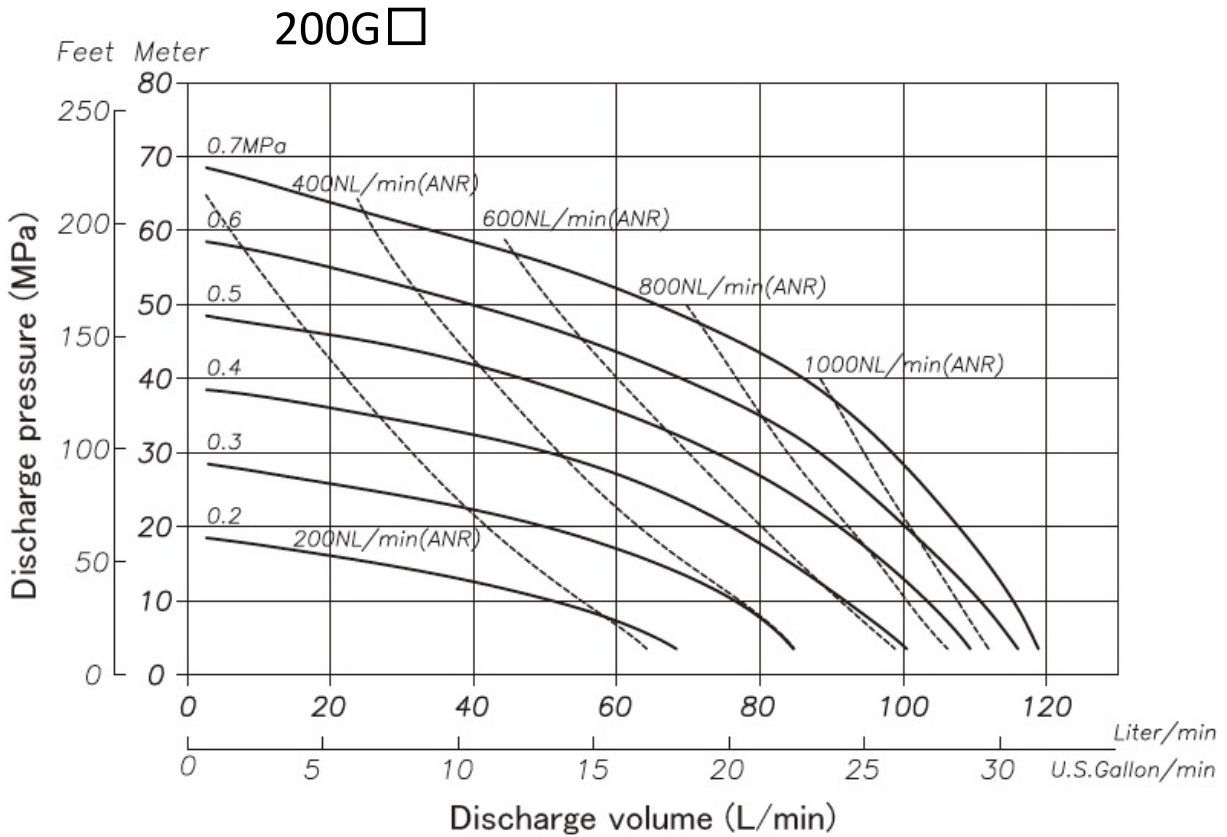

PTFE Diaphragm Curves

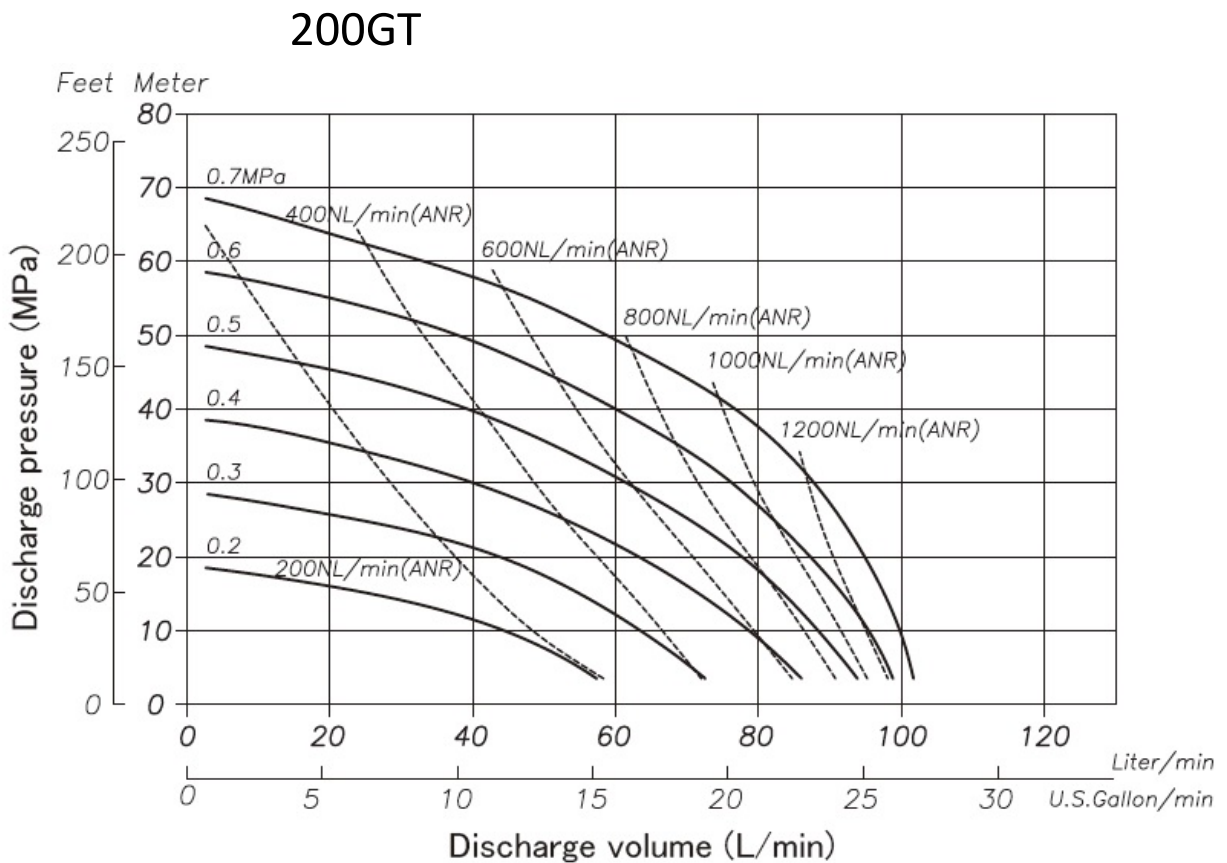

Wetted Materials Of Construction

MODEL	200GC □	200GN □	200GE □	200GV □	200GT □	200GH □	200GS □	200VE □	200VV □	200VT □	200VH □	200VS □
Pump Wetted Parts	PPG							PVDF				
Diaphragm	CR	NBR	EPDM	FKM	PTFE	TPEE	TPO	EPDM	FKM	PTFE	TPEE	TPO
Valve Stopper	PPG							PVDF				
Ball Valve	CR	NBR	EPDM	FKM	PTFE	NBR	EPDM	EPDM	FKM	PTFE	NBR	EPDM
Valve Seat	PPG							PVDF				
Center Disk	PPG							PVDF				
Weight	7.0 kg [15.5 lbs]							9.0 kg [19.8 lbs]				

Dimensional Drawings

MODEL	H	W	L	a	b	d	e	f	i	j	l	m	n	o	p	AIR INLET	AIR EXHAUST	LIQUID IN/OUT
200G □ [200G □ N]	368 [14.49]	316	373	194	32	65	256	182 [7.17]	203	80 [3.15]	196	177	150	125	200	Rc3/8 (VALVE: Rc1/4)	Rc3/4	Rc3/4 [NPT3/4]
200G □ J [200G □ A]	373 [14.69]							181 [7.13]		79 [3.11]						[NPT3/8] (VALVE: NPT1/4)		Equivalent to JIS Flange 10K20A [Equivalent to ANSI Flange 150 3/4B]
200V □ [200V □ N]	368 [14.49]	316	373	194	32	65	256	182 [7.17]	203	80 [3.15]	196	177	150	125	200	Rc3/8 (VALVE: Rc1/4)	Rc3/4	Rc3/4 [NPT3/4]
200V □ J [200V □ A]	373 [14.69]							181 [7.13]		79 [3.11]						[NPT3/8] (VALVE: NPT1/4)		Equivalent to JIS Flange 10K20A [Equivalent to ANSI Flange 150 3/4B]

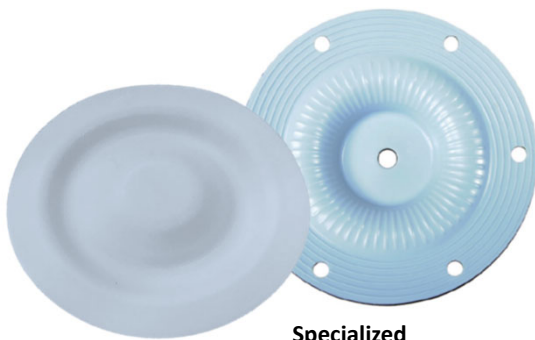
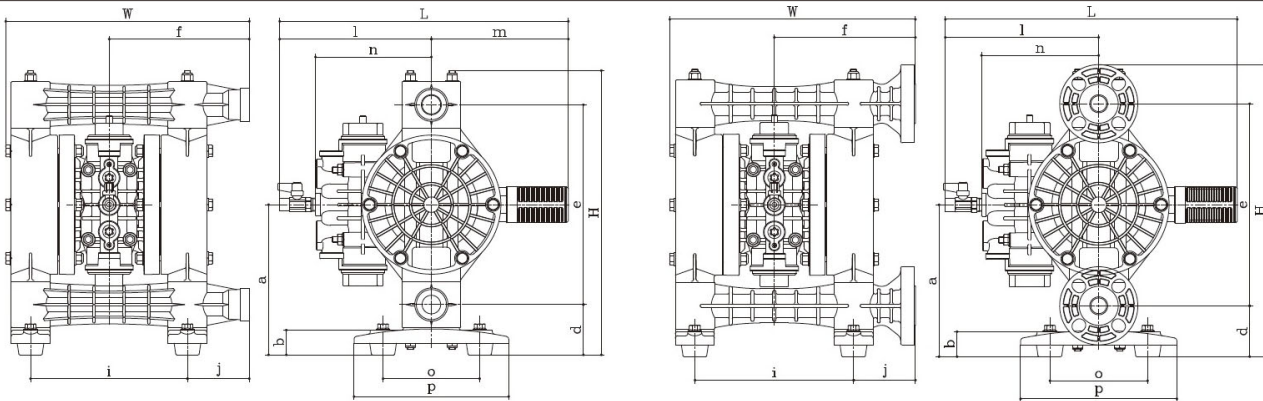

Specialized Diaphragm Options

Looped C® Air Spool

New Generation Spring Assisted Non-Centering Spool. Newly Improved with SUS Non-Centering Looped C® Springs. Original Ekonol® Seal Rings, Improved Spool Shaft. Outside Accessible with fully modular Spool Sleeve. Modern Long Life Materials of Construction. Oil & Grease Lubrication Free Design.



Made In Japan

TC-X

AODD Pump Capabilities.

- | | | |
|----------------------|-------------------------------|--------------------------------|
| Self Priming. | Variable Discharge Pressures. | Inherently Safe Design. |
| Run Dry. | Transfer Liquid Slurries. | Portable & Easy to Use. |
| Run up to Dead Head. | Transfer Large Sized Solids. | Transfer Viscous Fluids. |
| Variable Flow Rates. | Handle Abrasives. | Frequent Start Stop Operation. |
| Shear Sensitivity. | Transfer Chemicals. | Powered by Compressed Air. |

For more information about TC-X Pumps please contact: sales@yts-pump.com

©YTS Co Ltd Japan. All Rights Reserved 2020

Looped C®

CE Ex ATEX Compliant II 2GD c T5



JQA-QMA14279

091